

Dimensions mm [inches]

Tolerances acc. to DIN ISO 2768-m
Toleranzen gem. DIN ISO 2768-m

Isometric

Scale 5:1
Maßstab 5:1

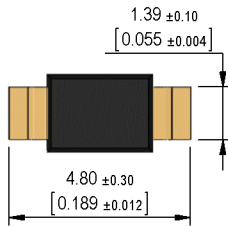
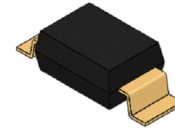
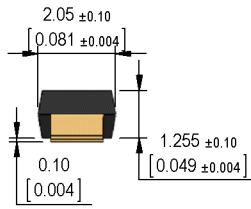
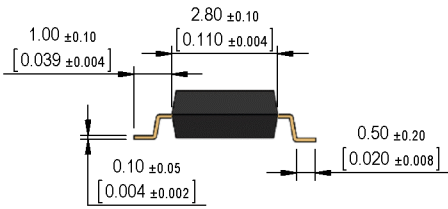

Schematic



Recommended PCB Pad Layout

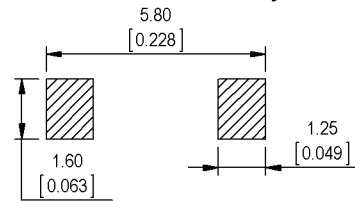

Warning: This device is especially designed for low voltage and low power sensing! The following points must be respected when the device is connected in a circuit:

- Voltage spikes (electrostatic or otherwise) across the terminals in the open mode are limited to 10 V.
- Switched voltages and current are limited to the maximum ratings.
- The parallel capacitance added across the switch is less than 100 pF.
- Minimize stray capacitance to be less than 100 pF in any lead circuit.
- The mounting and test equipment are properly grounded, as they may induce voltage spikes across the terminals.
- All handling is performed on a conductive mat and the operator is also grounded through a wrist contact bracelet.
- Permanent sticking or damage of the contacts may result whenever any of the above warnings are not respected.

Tape and Reel Packaging

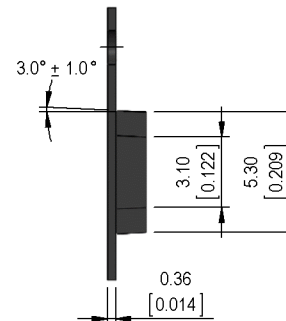
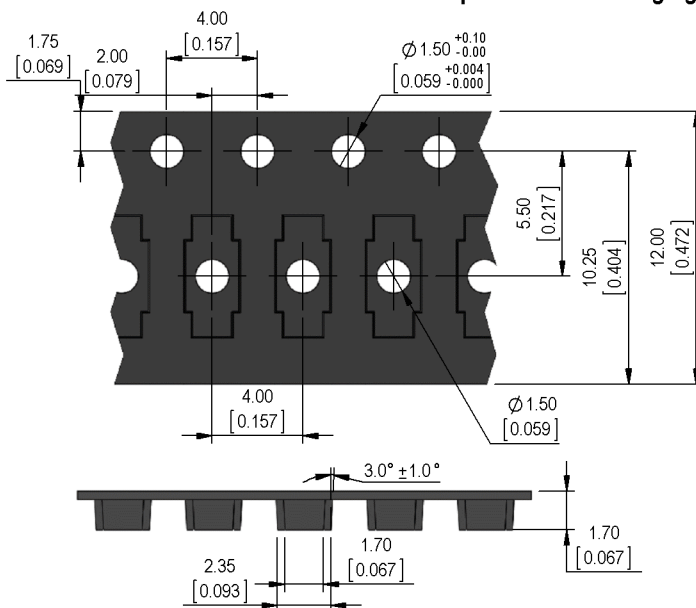

Products for tomorrow...

Magnetic properties	Conditions	Min	Typ	Max	Unit
Pull-In in milliTesla (modified conta	MS150 - phys. caused tolerance +/- 0,1mT	1		4	mT
Drop-Out in milliTesla (modified co	MS150 - phys. caused tolerance +/- 0,1mT	0.5			mT
Test equipment	Testing 100%	MMS Tester			

Contact Data	Conditions	Min	Typ	Max	Unit
Contact rating	Any DC combination of V & A not to exceed their individual max.'s			0.3	mW
Switching voltage	DC or Peak AC			3	V
Switching current	DC or Peak AC			100	µA
Carry current	DC or Peak AC			100	µA
Contact resistance static	Measured with 0.5V max. and 50µA		50	1,000	Ohm
Insulation resistance	RH <45 %, 30 V test voltage	1			GOhm
Breakdown voltage	according to IEC 255-5	50			VDC
Operate time incl. bounce	measured with 40% overdrive		0.1	1	ms
Release time	measured with no coil excitation		0.05	0.5	ms
Capacity	@ 10 kHz across open switch		0.2	0.5	pF

Environmental data	Conditions	Min	Typ	Max	Unit
Shock	1/2 sine, duration 11ms, in 3 axis			5,000	g
Vibration	from 10 - 2000 Hz			30	g
Operating temperature		-20		100	°C
Storage temperature		-55		150	°C
Soldering Temperature Tsold	3.5 sec. at			260	°C
Life Expectancy	Under 1.5V and 15µA	10,000,000			cycles
Remark	Au plated terminals: 40-55 µin. over 50-100 µin. Ni				

General data	Conditions	Min	Typ	Max	Unit
Packaging		500pcs per reel			

Special Requirements					
- Packaging: Tape & Reel (7 in. reels, 12 mm width, 4 mm pitch)					
- Marking: On Tape & Reel Packaging					
A. Supplier Part Number					
B. Supplier Lot Number or Date Code					
C. Quantity					

Mouser Electronics

Authorized Distributor

Click to View Pricing, Inventory, Delivery & Lifecycle Information:

[Standex Electronics:](#)

[MMS-B-2](#)